

£92,500

Homeryde House, Lee-on-the-Solent, PO13 9JD

DRAFT DETAILS : We are awaiting verification from the Vendor that these details are correct



- First Floor Retirement Apartment
- Lounge/Diner
- Kitchen
- Bathroom
- Resident's Lounge with Solent And Isle Wight Views
- Laundry Room
- Communal Gardens
- Resident's Permit Parking (subject to availability)
- Lift To All Floors
- Energy Efficiency Rating:- C(80)

Property Reference : L2525

Council Tax Band: B

Score	Energy rating	Current	Potential
92+	A		
81-91	B		85 B
69-80	C	80 C	
55-68	D		
39-54	E		
21-38	F		
1-20	G		

Floor Plans (For illustrative purposes and not drawn exactly to scale)

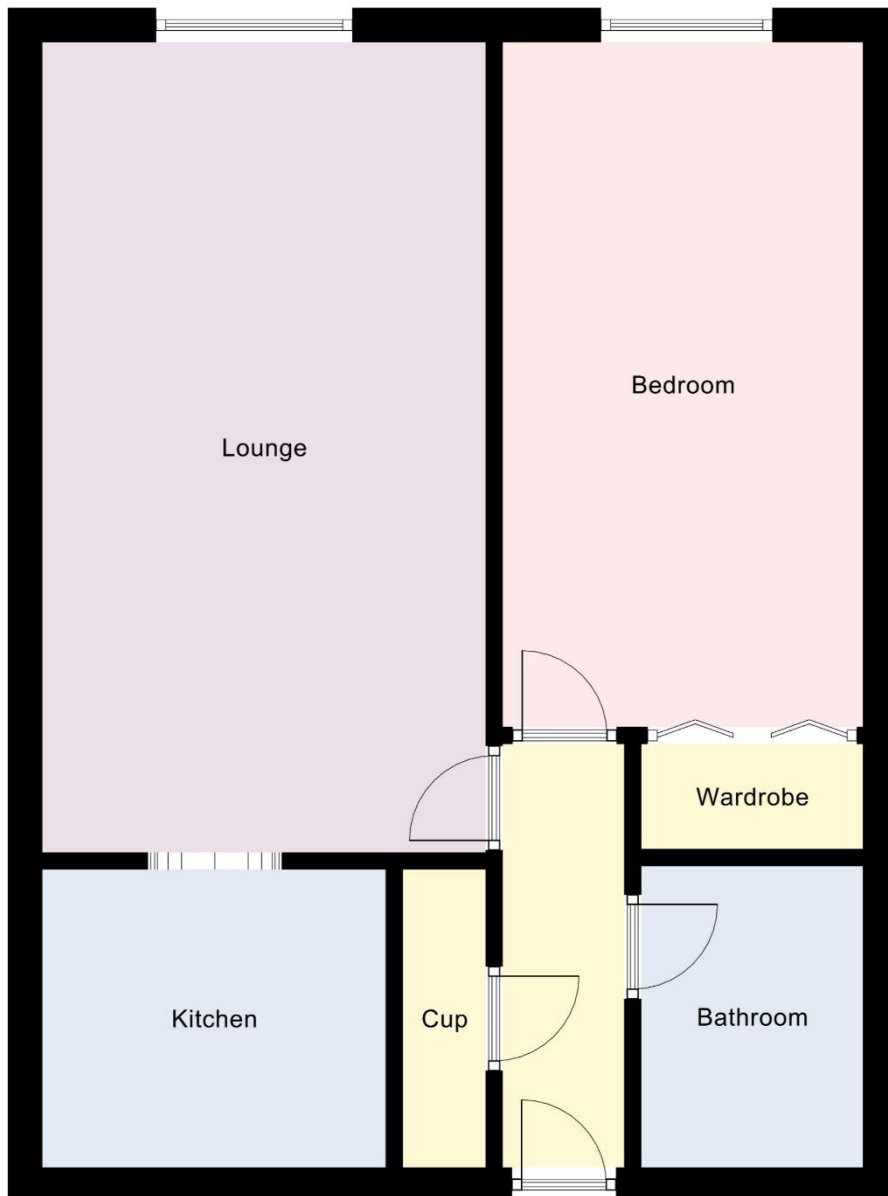

The Accommodation Comprises:-

Security entrance system and door to:-

Communal Entrance Hall:-

Stairs and lift to all floors, laundry room.

Communal Lounge:-

Seating area with communal kitchen.



Apartment:-

Front door to:-

Entrance Hall:-

Textured and covered ceilings, storage cupboard with light housing fuse box, meters and hot water tank, emergency pull cord.

Lounge/ Diner:-

19' 6" x 10' 8" (5.94m x 3.25m)

Textured and covered ceilings, UPVC double glazed window to front elevation, wall mounted electric heater, security entrance phone, arch to:-



Kitchen:-

8' 8" x 7' 2" (2.64m x 2.18m)

Coved ceilings, fitted with a range of base cupboards and matching eye level units, roll top work surfaces, tiled walls, extractor fan, space for cooker, single drainer stainless steel sink unit, space for tall fridge/freezer, space for slimline dishwasher, extractor fan, multiple electric points.



Spacious Bedroom:-

19' 5" x 8' 8" (5.92m x 2.64m)

Textured and covered ceilings, UPVC double glazed window to front elevation, wall mounted electric heater, built in wardrobe with hanging space and shelving.



Bathroom:-

6' 8" x 5' 4" (2.03m x 1.63m)

Coved ceilings, tiled walls, close coupled WC, wash hand basin set in vanity unit, panelled bath with electric power shower over, towel rail, wall mounted Dimplex electric heater, extractor fan, fixed mirror with light over.



Outside:-

There is communal gardens, clothes drying area and residents permit parking area.



Disclaimer: These particulars are set out as a general outline in accordance with the Consumer Protection from Unfair Trading Regulations 2008 (CPR's) and Business Protection from Misleading Marketing Regulations 2008 (BPR's) only for the guidance of intending purchasers or lessees, and do not constitute any part of an offer or contract. Details are given without any responsibility, and any intending purchasers, lessees or third parties should not rely on them as statements or representations of fact, but must satisfy themselves by inspection or otherwise as to the correctness of each of them.

We have not carried out a structural survey and the services, appliances and specific fittings have not been tested. All photographs, measurements, floor plans and distances referred to are given as a guide only and should not be relied upon for the purchase of carpets or any other fixtures or fittings. Gardens, roof terraces, balconies and communal gardens as well as tenure and lease details cannot have their accuracy guaranteed for intending purchasers. Lease details, service ground rent (where applicable) are given as a guide only and should be checked and confirmed by your solicitor prior to exchange of contracts.

No person in the employment of Fenwicks Estates Ltd has any authority to make any representation or warranty whatever in relation to this property. Purchase prices, rents or other prices quoted are correct at the date of publication and, unless otherwise stated, exclusive of VAT.

Data Protection: We retain the copyright in all advertising material used to market this Property.

Money Laundering Regulations 2017: Intending purchasers will be required to produce identification documentation once an offer is accepted